

Zaślepka końcowa Model 300



Specyfikacja materiałowa

- Korpus - żeliwo, ASTM A536

Wykończenie

- Malowane – czerwony (RAL 3000)
- Ocynkowane

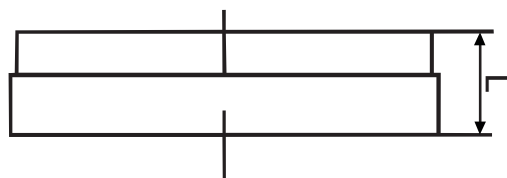

Model (czerwone)	Model (ocynkowane)	Rozmiar mm/in	Średnica zewn. rury mm/in	Max ciśnienie robocze bar/psi			Wymiar L mm/in
				UL	FM	VdS	
RD300P033	RD300P033G	25 1	33.7 1.315	-	-	16 232	22.1 0.87
RD300P042	RD300P042G	32 1¼	42.4 1.660	34.5 500	34.5 500	16 232	23.5 0.93
RD300P048	RD300P048G	40 1½	48.3 1.900	34.5 500	34.5 500	16 232	23.5 0.93
RD300P060	RD300P060G	50 2	60.3 2.375	34.5 500	34.5 500	16 232	23.5 0.93
RD300P076	RD300P076G	65 2½	76.1 3.000	34.5 500	34.5 500	16 232	24.5 0.96
RD300P089	RD300P089G	80 3	88.9 3.500	34.5 500	34.5 500	16 232	24 1.00
RD300P114	RD300P114G	100 4	114.3 4.500	34.5 500	34.5 500	16 232	27 1.06
RD300P139	RD300P139G	125 5	139.7 5.500	34.5 500	34.5 500	16 232	25.5 1.00
RD300P168	RD300P168G	150 6	168.3 6.625	34.5 500	34.5 500	16 232	24.5 0.97
RD300P219	RD300P219G	200 8	219.1 8.625	34.5 500	34.5 500	16 232	30.5 1.20
RD300P273	RD300P273G	250 10	273.9 10.750	34.5 500	34.5 500	16 232	32 1.26
RD300P323	RD300P323G	300 12	323.9 12.750	34.5 500	34.5 500	16 232	32 1.26